

© Bosch Engineering GmbH. Alle Rechte vorbehalten, auch bzgl. jeder Verfügung, Verwertung, Reproduktion, Bearbeitung, Weitergabe sowie für den Fall von Schutzrechtsanmeldungen.

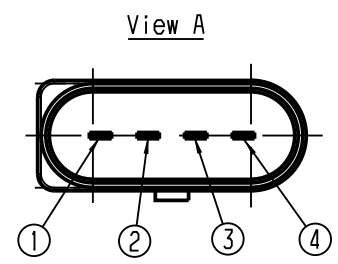
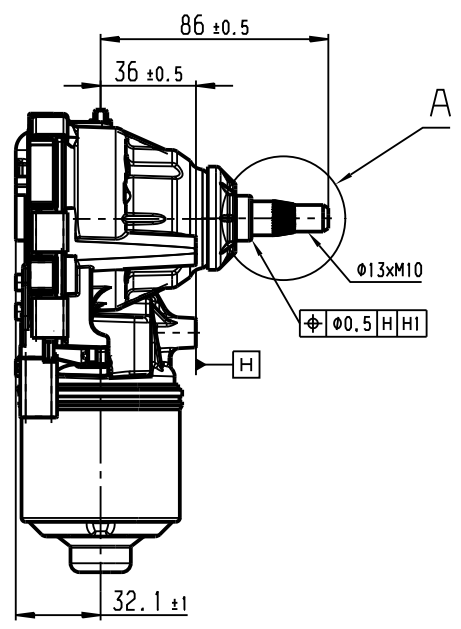
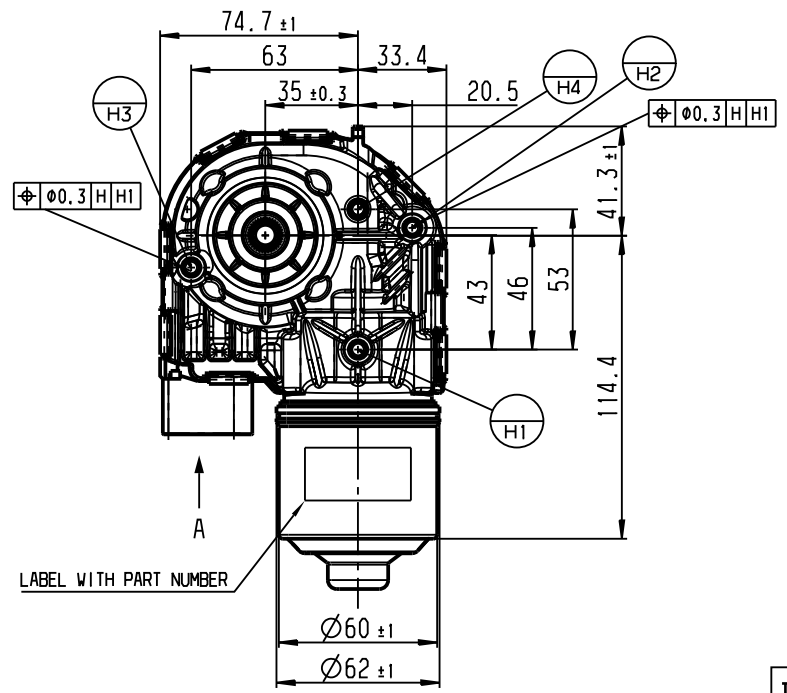

Connector: CEP2M-AMP-4

PIN 1: LIN

PIN 2: free

PIN 3: Ground

PIN 4: Power Supply 9 ... 16V

LABEL WITH PART NUMBER

Characteristic curve

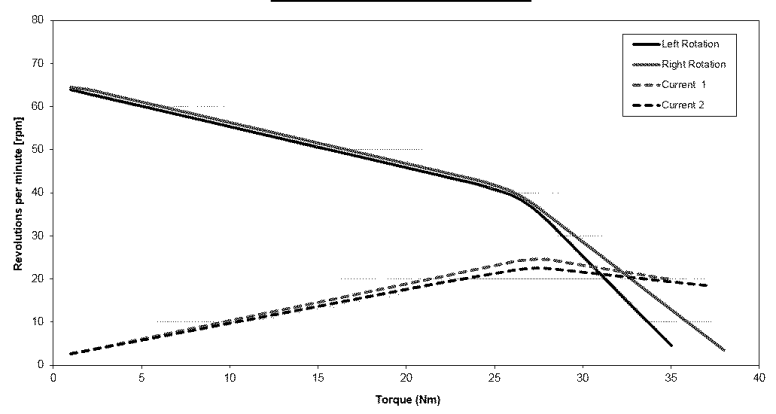

Motor with electronics, measurement in rotating mode without resistance.

Delivery status

- The motor will be delivered with three mounting screws.
- The screws are pre-assembled with a few thread turns.
- Self-tapping screw referred to DIN 7500
- PE M6x20
- Maximum tightening torque: 8Nm

**Technical Data**

Operating Temperature: -40...85°C  
 Maximal Vibration: 13,9m/s<sub>eff</sub> DIN EN 60068-2-64  
 Maximal Wiping Speed: Depends on torque  
 Maximal Wiping Angle: 160°  
 Maximal Torque: 35Nm  
 Power Supply: 9...16V

Please use the calibration sheet for you order to define angles and speed of the WDA.

Please be sure you are using the correct LDF\* file

You will find further information about the LIN-Messages in the technical data sheet of the WDA.

Please ensure that the master counter is running during the operation of the WDA. Otherwise it will work improperly. You will find further information about using the master counter in the LDF file of the wiper motor.

The application angle can be only modified by Bosch Motorsport.

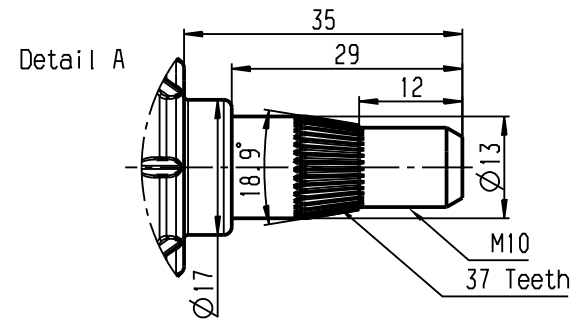

Shaft according to DIN 72783-A1

General tolerances for/Allgemeintoleranzen fuer		
lin. dim./L. masse	radii/Radien	angles/Winkel
± 1	± 0,5	± 2°
size acc. to/Masse nach		
ISO 14405-1:2010-12		
envelope principle / Huellprinzip		ⓔ

01 Erstellung	20161024	SKR	6722BEG/MSD-P Behrens	
Ind. Change/Änd.	YYYYMMDD	Drawn/Gez.	Checked/Gepr.	Releas./Freig.
Lang./Spr.	Syst.	Wght./Gew.	BWN	Resp. dept./Verantw. Abt.
en/de	CAT	--		Add. info./Zus. Info.
Scale/M.stab	1:1	<b>BOSCH</b>		Wiper Direct Actuator - WDA Wischerdirektantrieb - WDA
MNR	--	OFFER DRAWING ANGEBOTSZEICHN.	Doc. type AGZ	1/1
			F 02U V00 838-04	DP/TD Ind. Format A3
			Repl. for	Repl. by

© Bosch Engineering GmbH. All rights reserved, also regarding any disposal, exploitation, reproduction, editing, distribution, as well as in the event of applications for industrial property rights.